

# For Sale

Spring Grove, Illinois

22 ACRES

## PROPERTY SPECIFICS:

- Land Size: 21.59 acres
- Lot Dimensions:  
1317.58' x 714.56'
- Sewer & Water: Septic and Well
- Zoning: B-2 (General Business District)
- Real Estate Taxes: \$147.36
- Route 173 & Siedschlag Rd
- Sale Price: \$2,774,358 (\$2.95 psf)



## Development Site 1,317' of Route 173 Frontage

### DESCRIPTION OF PROPERTY:

21.59 acres at the corner of Route 173 & Siedschlag Rd in a rapid growth area. This site is located near numerous subdivisions, including 4 brand new development sites. This vacant commercial dev. site includes an "on-site" water detention already provided, flat topography, high traffic counts, and possible full access on Siedschlag Rd. including right-in, right-out on Route 173. Retail would pull from a number of surrounding communities.

### STRONG DEMOGRAPHICS:

	3 Mile	5 Miles	7 Miles
Population	7,668	33,590	81,651
Average Income	\$82,386	\$68,852	\$66,942

### TRAFFIC COUNTS:

8,100 vehicles per day (doubling in summer months)



**Sherry Wagner - (312)-637-9887**  
[sw@wagnercommercial.com](mailto:sw@wagnercommercial.com)

**Jenny Lewis - (847)-346-6644**  
[jenny@wagnercommercial.com](mailto:jenny@wagnercommercial.com)



All information herein is from sources deemed reliable but not guaranteed accurate.  
Subject to errors, omissions, and to change of price or terms, prior to sale or lease, all without notice.

**WAGNER COMMERCIAL**  
[www.wagnercommercial.com](http://www.wagnercommercial.com)

# For Sale

Spring Grove, Illinois



22 ACRES

## Property Tax Map

Route 173 & Siedschlag Rd

PIN: 05-07-200-006

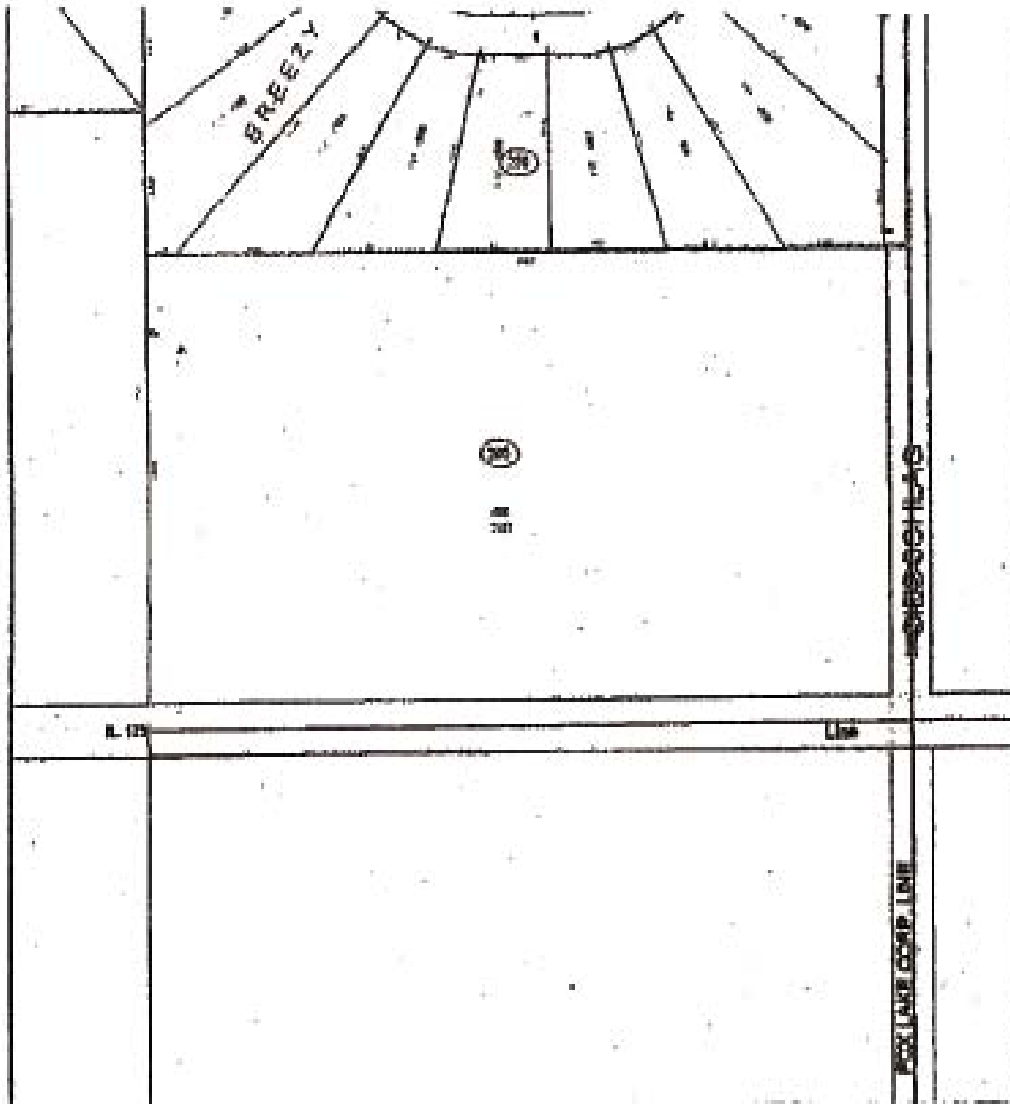

300 600 900 feet

**Sherry Wagner** - (312)-637-9887  
sw@wagnercommercial.com

**Jenny Lewis** - (847)-346-6644  
jenny@wagnercommercial.com



All information herein is from sources deemed reliable but not guaranteed accurate.  
Subject to errors, omissions, and to change of price or terms, prior to sale or lease, all without notice.

**WAGNER COMMERCIAL**  
www.wagnercommercial.com

# For Sale

Spring Grove, Illinois



## Land for Development

1,317' of Route 173 Frontage

22 ACRES

Route 173 & Siedschlag Rd

PIN: 05-07-200-006



**Sherry Wagner - (312)-637-9887**  
sw@wagnercommercial.com

**Jenny Lewis - (847)-346-6644**  
jenny@wagnercommercial.com



All information herein is from sources deemed reliable but not guaranteed accurate.  
Subject to errors, omissions, and to change of price or terms, prior to sale or lease, all without notice.

**WAGNER COMMERCIAL**  
www.wagnercommercial.com